

TED (15) – 3183

Reg. No.....

(REVISION — 2015)

Signature .....

DIPLOMA EXAMINATION IN ENGINEERING/TECHNOLOGY/  
MANAGEMENT/COMMERCIAL PRACTICE — OCTOBER, 2017

ARCHITECTURAL DRAWING – I

[Time : 3 hours

(Maximum marks : 100)

PART — A

(Maximum marks : 10)

Marks

I Answer *all* questions in one or two sentences. Each question carries 2 marks.

1. State the use of perspective drawing.
2. Define rendering in architectural drawing.
3. Give minimum height required for a writing table and seat of a chair.
4. Define plinth.
5. Differentiate between sill level and lintel level.

(5×2 = 10)

PART — B

(Maximum marks : 20)

II Draw the perspective view of the given plan and render it.

20

PART — C

(Maximum marks : 70)

III Design a milk booth in a bus stand. Maximum area should be below 10 sq.m.

- (i) Give a brief description about the spaces to be provided and their required area. 12
- (ii) Write a note on your idea about the form and development of area. 8
- (iii) Plan 20
- (iv) Elevation 10
- (v) Section. 20

[278]

[P.T.O.]

Q4 →

2

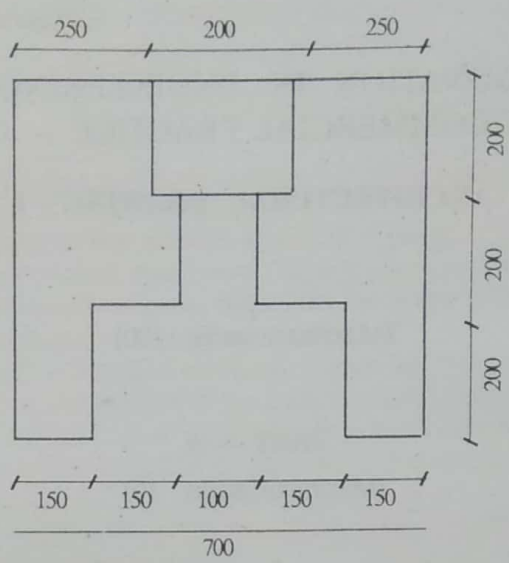

PLAN

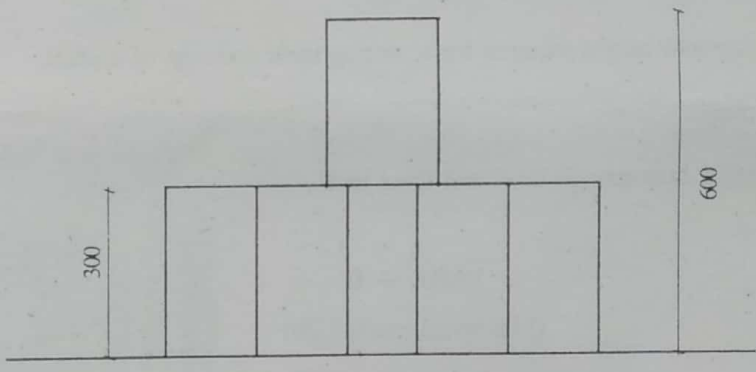

ELEVATION

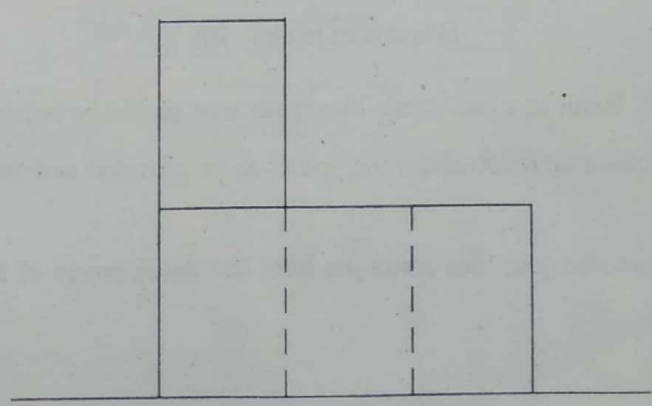

SIDE ELEVATION