

*Fourth Semester Diploma Examination in Architecture
October 2012*

ARCHITECTURAL DRAWING - II

Maximum marks:-100

Time:- 4 hours
Marks

- Note:- 1. Drawing shall be neat and fully dimensioned.
2. Missing data can be suitably assumed.
3. One butter sheet and one tracing sheet size 75cm x 50 cm are to be supplied.

PART - A

I. Answer the following questions in one or two sentences. Each question carries 2 marks.

1. What are different types of rendering?
2. Draw the symbols for representing brick and concrete in section.
3. What is meant by 'three point' perspective?
4. List out by name four different roof types.
5. Define 'picture plane'.

(5 x 2 = 10)

PART - B

II. Trace the given figure 1 to your drawing sheet and render it in any medium
Incorporate appropriate rendering element like human figures, trees, plants, vehicles
and furniture etc. (20)

PART - C

III. Design a weekend cottage with following requirements.

1. Sit out - 5m²
2. Living room - 12m²
3. Bed room - 10 m²
4. Kitchen - 6 m²
5. Toilet - 3 m²

The site measures 30m (EW) x 35m (SW) with 12m wide road abutting the shorter side.
Drawing shall include: (70)

Plan showing furniture lay out -	1:100	[25]
Elevation	- 1:100	[10]
Section	- 1:100	[20]
Site plan	- 1:400	[5]
Rendered perspective		[10]

.....

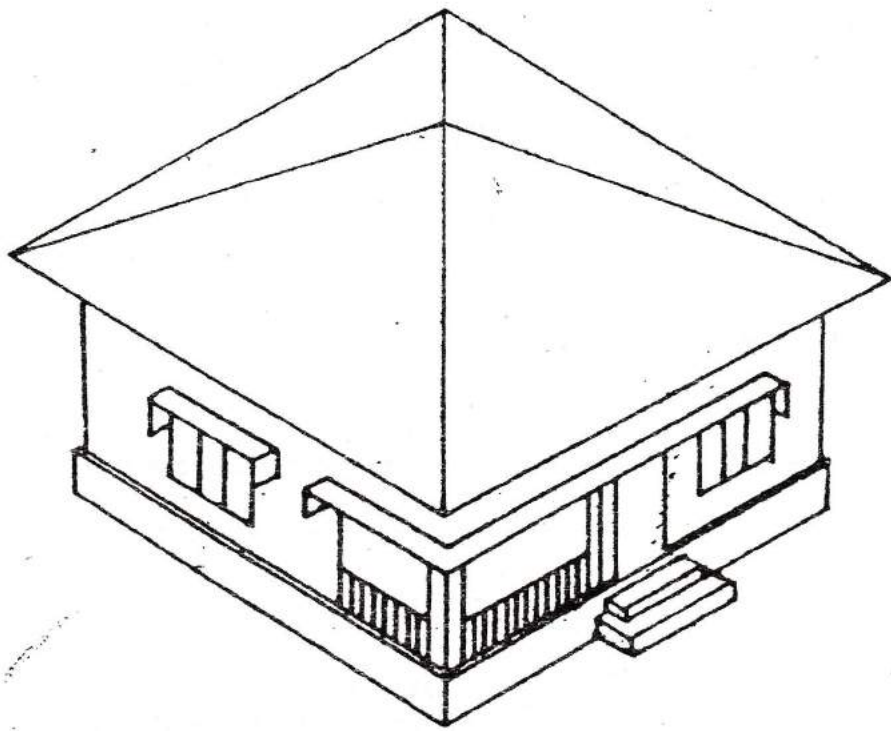

FIG: NO:1