

FOURTH SEMESTER DIPLOMA EXAMINATION IN
ARCHITECTURE — APRIL, 2017

ARCHITECTURAL DRAWING – II

[Time : 4 hours

(Maximum marks : 100)

- [Note :—1. Drawing shall be neat and fully dimensioned.
2. Missing data can be suitably assumed.
3. Two A2 size tracing sheet and two butter sheets are to be supplied.]

PART — A

(Maximum marks : 10)

Marks

I Answer the following questions in one or two sentences. Each question carries 2 marks.

1. Define floor area ratio.
2. State the meaning of "Mezzanine Floor".
3. Assess the number of wash basins required for a wedding hall of about 250 female capacity as per KBR.
4. Draw a section and label :
Plinth, Lintel, Ceiling slab.
5. Define travel distance.

(5×2 = 10)

PART — B

(Maximum marks : 20)

II Show the furniture arrangement for a living room of size 400 cm × 420 cm. Demonstrate the design features in elevation of any two walls.

20

PART — C

(Maximum marks : 70)

III Design a Small Recreational Club of 300 capacity with the following requirements.

- (a) Lobby, Waiting and Reception – 30 sq.m.
- (b) Office – 10 sq.m.
- (c) Meeting Hall with stage, Green room and toilets – 450 sq.m. + 60 sq.m.
- (d) Public toilet

[P.T.O.]

- (e) Dining space - 150 persons – 280 sq. m.
- (f) Wash area
- (g) Toilet
- (h) Kitchen - 30 sq.m.
- (i) Pantry - 10 sq.m.
- (j) Work area - 20 sq.m.
- (k) Store - 10 sq.m.
- (l) Dish wash area - 20 sq.m.
- (m) Sports centre
- (n) Parking spaces for vehicles

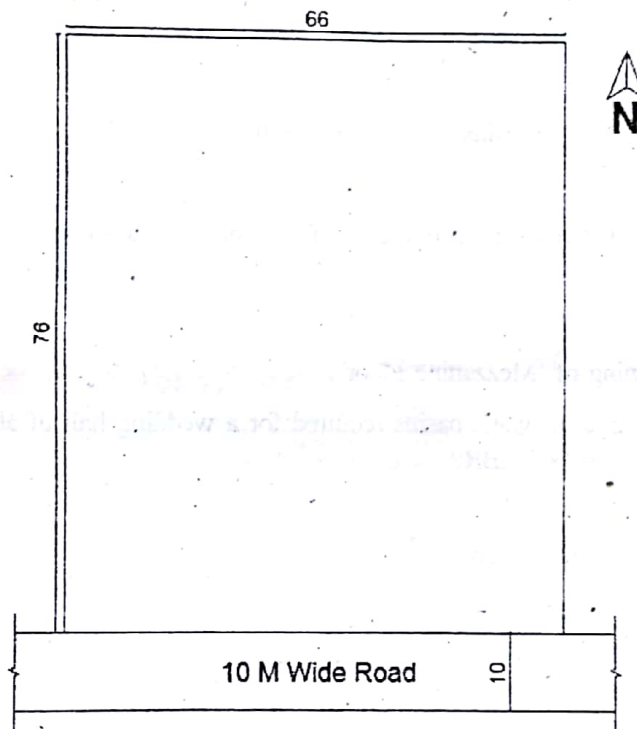

Plan showing furniture layout 1 : 100	25
Elevation 1 : 100	10
Section 1 : 100	20
Site plan showing parking and landscape 1 : 200	15